

PLACER VILLAGE SHOPPING CENTER

Placer County | California

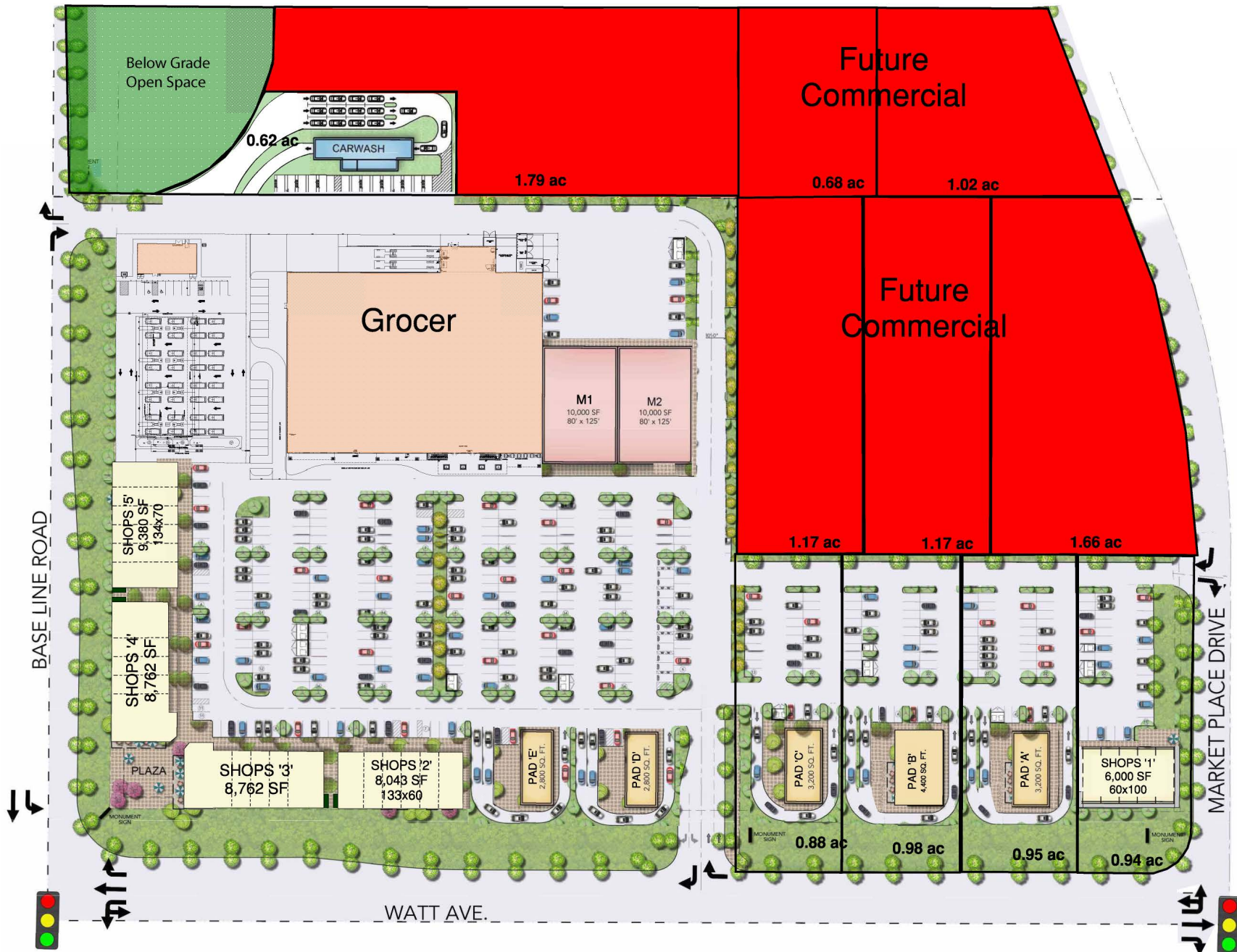

SEC Baseline Road & Watt Avenue

SITE SUMMARY

Gross site area: 18.34 ac

COMMERCIAL

| Use | SF |
|------------------------|------------------|
| Retail | |
| A1-Grocer | |
| M 1 | 10,000 sf |
| M 2 | 10,000 sf |
| Shops 1 | 13,200 sf |
| Shops 2 | 14,400 sf |
| Car Wash | 3,200 sf |
| C-Store at Gas Station | 2,200 sf |
| Fast Food | |
| Pad A | 2,800 sf |
| Pad B | 4,400 sf |
| Pad C | 3,200 sf |
| Pad D | 2,800 sf |
| Pad E | 2,800 sf |
| Total | 21,700 sf |

PARKING SUMMARY

Parking Provided: 535 spaces + 12EV
 Parking Ratio: 4.20 spaces per 1,000 sf

TRADE AREA

43,500 Existing,
Under Construction and Approved Residential Units

